

23,500 Sq. Ft. Warehouse FOR LEASE

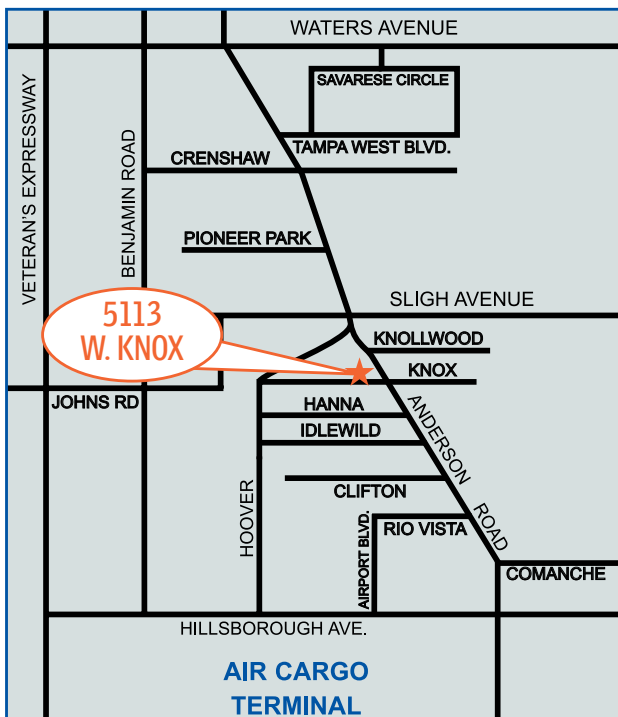

**5113 W. Knox Street
Tampa, FL 33634**



SPACE SIZE:	23,500 sq. ft.
OFFICE/SHOWROOM:	4,800 sq. ft.
WAREHOUSE:	18,700 sq. ft.
LOADING:	2 Dock Doors
CLEAR HEIGHT:	18 to 27 Feet
POWER:	3 Phase Available
CONSTRUCTION:	Concrete Block
LEASE RATE:	\$1.95 NNN
AVAILABLE:	In 30 Days

FOR MORE INFORMATION CONTACT:

Industrial Property Group, Inc.

Licensed Real Estate Broker

2202 N. Westshore Blvd. • Suite 200 • Tampa, FL 33607

CRAIG M. CAPO at craig@capoindustrial.com

Office: 813.639.7577 • Cell: 813.335.3361

www.tampaindustrialrealestate.net

No warranty or representation, expressed or implied, is made as to the accuracy of the information contained herein, and same is submitted subject to errors, omissions, change of price, rental or other conditions, withdrawal without notice, and to any special listing conditions imposed by our principals.

**5113 W. Knox St.
Tampa, FL 33634**

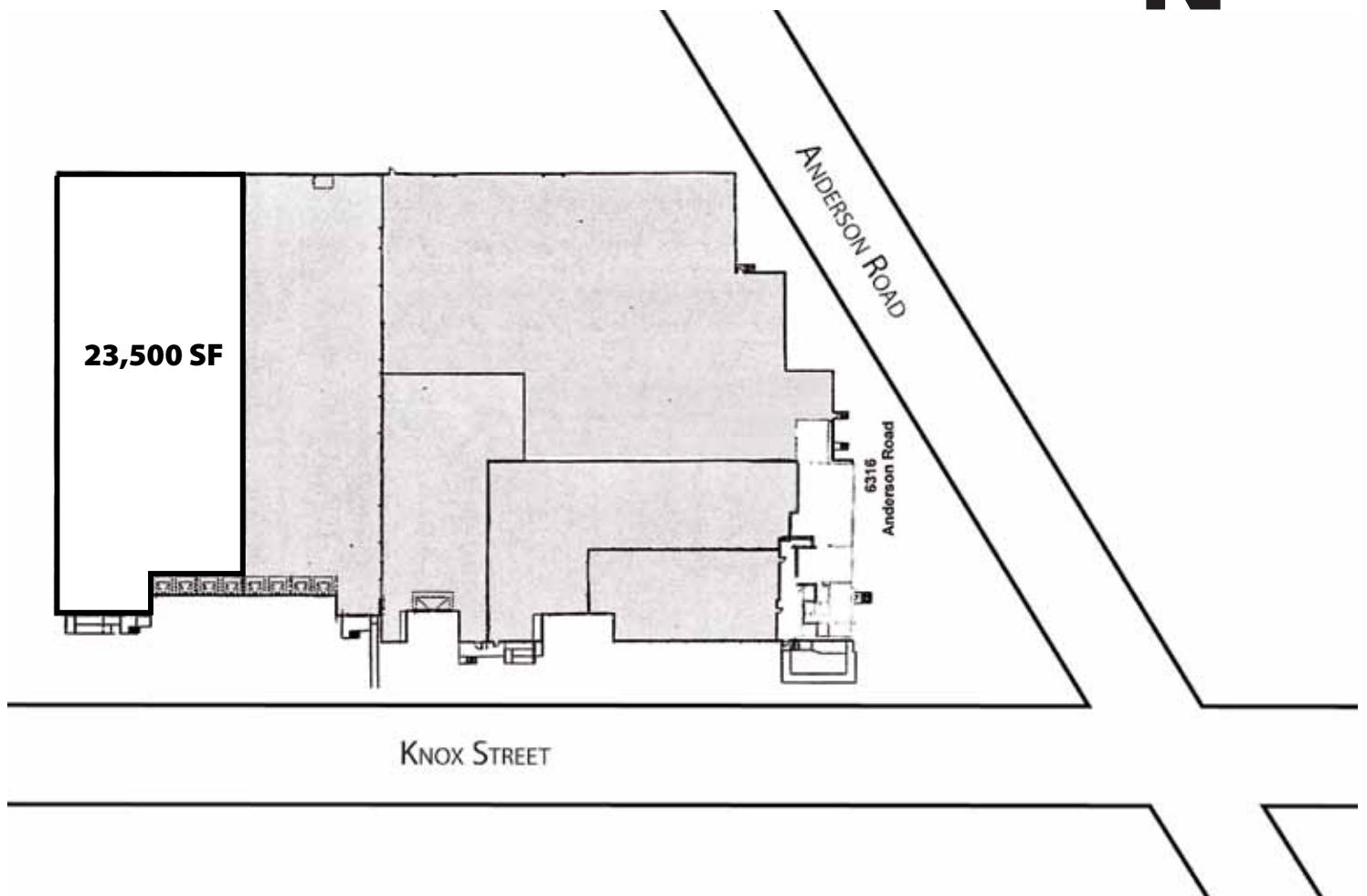

Industrial Property Group, Inc.
Licensed Real Estate Broker

FOR MORE INFORMATION CONTACT:
CRAIG M. CAPO at craig@capoindustrial.com
2202 N. Westshore Blvd. • Suite 200 • Tampa, FL 33607
Office: 813.639.7577 • Cell: 813.335.3361
www.tampaindustrialrealestate.net