

# 4,000 Sq. Ft. WAREHOUSE w/ 4,000 Sq. Ft. Fenced Outside Storage

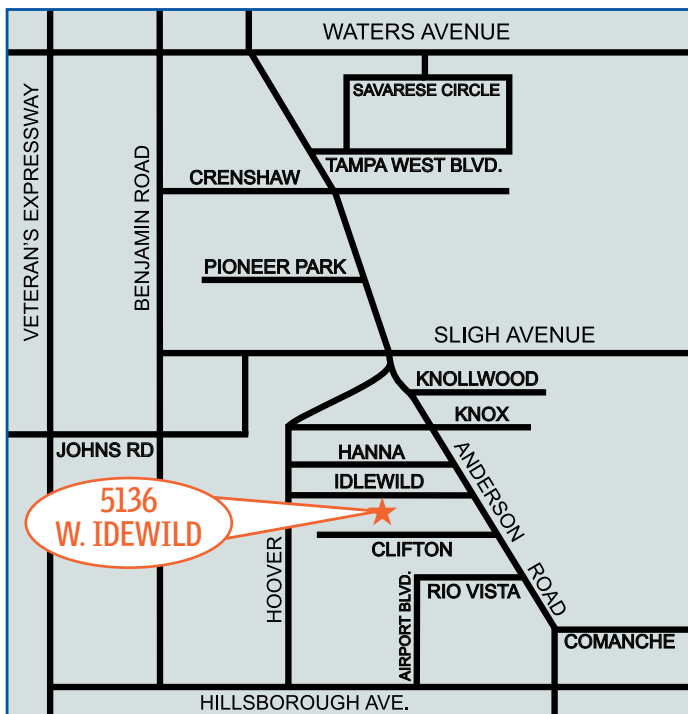

**5136 W. Idlewild Avenue  
Tampa, FL 33634**



<b>SPACE SIZE:</b>	4,000 Square Feet
<b>OFFICE:</b>	800 Square Feet
<b>WAREHOUSE:</b>	3,200 Square Feet
<b>FREE MEZZANINE:</b>	800 Square Feet
<b>OUTSIDE STORAGE:</b>	40' x 100' Fenced Area
<b>LOADING:</b>	1 Grade Level (10' x 12')
<b>CLEAR HEIGHT:</b>	20 Feet
<b>POWER:</b>	3 Phase
<b>CONSTRUCTION:</b>	Concrete Block
<b>LEASE RATE:</b>	\$3.95 NNN

FOR MORE INFORMATION CONTACT:

**Industrial Property Group, Inc.**

Licensed Real Estate Broker

2202 N. Westshore Blvd. • Suite 200 • Tampa, FL 33607

**CRAIG M. CAPO** at [craig@capoindustrial.com](mailto:craig@capoindustrial.com)

Office: 813.639.7577 • Cell: 813.335.3361

[www.tampaindustrialrealestate.net](http://www.tampaindustrialrealestate.net)

No warranty or representation, expressed or implied, is made as to the accuracy of the information contained herein, and same is submitted subject to errors, omissions, change of price, rental or other conditions, withdrawal without notice, and to any special listing conditions imposed by our principals.

**5136 W. Idlewild Ave.  
Tampa, FL 33634**

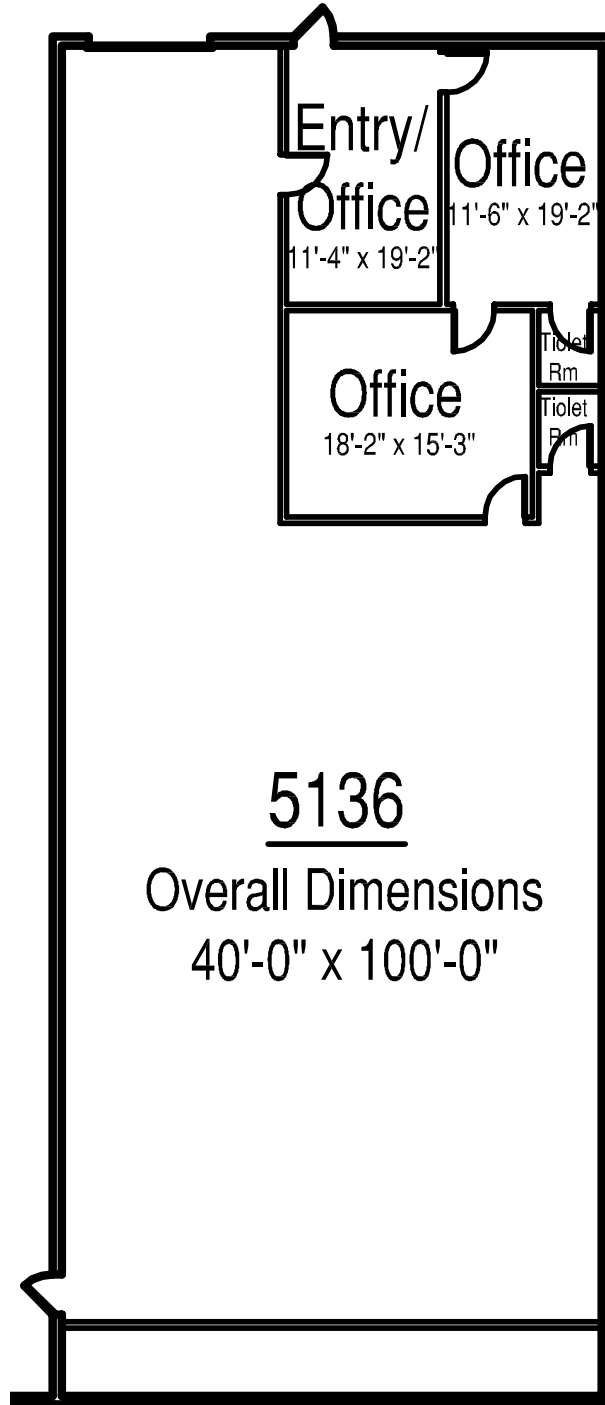

**Industrial Property Group, Inc.**

Licensed Real Estate Broker

2202 N. Westshore Blvd. • Suite 200 • Tampa, FL 33607

FOR MORE INFORMATION CONTACT:

**CRAIG M. CAPO** at [craig@capoindustrial.com](mailto:craig@capoindustrial.com)

Office: 813.639.7577 • Cell: 813.335.3361

**[www.tampaindustrialrealestate.net](http://www.tampaindustrialrealestate.net)**

No warranty or representation, expressed or implied, is made as to the accuracy of the information contained herein, and same is submitted subject to errors, omissions, change of price, rental or other conditions, withdrawal without notice, and to any special listing conditions imposed by our principals.